

Lid Replacement Kits

product description

Standard kits are now available to facilitate the replacement of DSN/DS/DR lids in the field. These kits allow customers to replace broken receptacle lids which are currently riveted to the casings.

Each kit includes a lid, required hardware, and instructions.

Kit hardware includes:

- Screw designed specifically for attaching Meltric replacement lids
- Locking nut
- Flat washers
- Lid spring

All kit hardware parts are stainless steel.

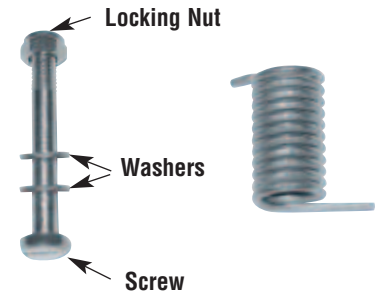

(DS200/DR250 kits also include a rivet - see instructions for specific installation directions.)

ordering instructions and pricing

Part numbers for “normally open” and “normally closed” lids are the same though installation instructions vary.

Model	Material*	Part Num	List Price
DSN20	POLY	61-1A125	\$ 8.20
DSN30	POLY	61-3A125	\$18.40
DSN60	POLY	61-6A125	\$26.20
DS20/DR30	POLY	31-1A125	\$18.40
DS30/DR50	POLY	31-3A125	\$26.20
DS60/DR100	POLY	31-6A125	\$28.70
DS100/DR150	POLY	31-9A125	\$33.00
DS60/DR100	METAL	39-6A925	\$32.80
DS100/DR150	METAL	39-9A925	\$39.40
DS200/DR250	METAL	39-2A925	\$48.50

*Lid material and casing material of existing receptacle.

Note: Future editions of the product catalog will include lid replacement kit part numbers in the appropriate spare parts sections.

replacement of poly lids

Depending on the device, the lid is either retained by a roll pin or rivet. Directions for both scenarios are included with the replacement kits and they are shown on the following pages.

INSTRUCTIONS

REPLACEMENT OF DS/DSN POLY LIDS IN THE FIELD

WARNING!
FOLLOW MANUFACTURER'S SAFETY AND OPERATIONAL GUIDELINES WITH ANY TOOL AND/OR EQUIPMENT USED IN THIS REPLACEMENT PROCEDURE. WEAR SAFETY GLASSES!

STEP 1

The device is supplied with the lid either "normally open" or "normally closed" depending on how the spring is installed. Using the series of photos that follow, identify the device being repaired and install the spring as shown so that the lid is "normally open" or "normally closed" as desired.



Normally Open

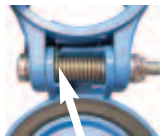

Normally Closed

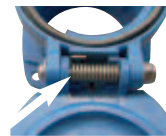

Normally Open

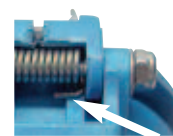

Normally Closed

Spring positions for DSN30, DS20, DS30 and DS60 devices.

Spring positions for DSN20 device.

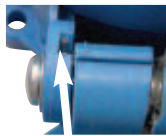

Normally Open

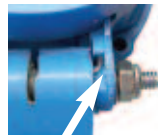

Normally Closed

Spring positions for DSN60 device.

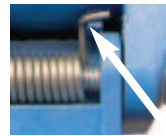

Normally Open

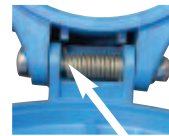

Normally Closed

Spring positions for DS100 device.



4640 Ironwood Dr. • Franklin, WI 53132 • 800.433.7642 • Fax: 414.817.6161

CUSTINFO LidReplacement Kit 050808 C



STEP 2

Depending on the device, the lid is either retained by a roll pin or a rivet.
a) For roll pin construction, drive the roll pin out with a hammer using an appropriately sized punch.



STEP 2 (cont.)

b) For riveted construction, the rivet needs to be cut mid-shank in order to be removed. We recommend use of a Dremel tool (or equivalent) to carefully saw through the lid and through the rivet shank.



STEP 2 b) (cont.)

In the course of sawing through the rivet, stop occasionally to ensure that the blade is not cutting through to the casing.



STEP 2 b) (cont.)

After the rivet has been cut, each end of the rivet can be pried out using a slotted screwdriver inserted into the cut.



STEP 3

Replace the lid and spring making sure that the spring is properly in its seated position. Two washers are provided: one to position under the screw head and the other under the lock nut. Line up the lid hole with the casing mounting holes and insert screw shank through the hole.

STEP 4

Drive the lock nut onto the screw but do not over-tighten as the lid must be loose enough to pivot about the screw shank.



4640 Ironwood Dr. • Franklin, WI 53132 • 800.433.7642 • Fax: 414.817.6161

CUSTINFO LidReplacement Kit 050808 C

replacement of metal lids

INSTRUCTIONS

REPLACEMENT OF DS METAL LID IN THE FIELD

WARNING!
FOLLOW MANUFACTURER'S SAFETY AND OPERATIONAL GUIDELINES WITH ANY TOOL AND/OR EQUIPMENT USED IN THIS REPLACEMENT PROCEDURE. WEAR SAFETY GLASSES!

STEP 1
The device is supplied with the lid either "normally open" or "normally closed" depending on how the spring is installed. Using the series of photos that follow, identify the device being repaired and install the spring as shown so that the lid is "normally open" or "normally closed" as desired.



Normally Open



Normally Closed

Spring positions for DS60 and DS100C devices.

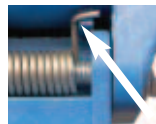

Normally Open



Normally Closed

Spring positions for DS100 and DS200 devices.



STEP 2
Depending on the device, the lid is either retained by a roll pin or a rivet.
a) For roll pin construction, drive the roll pin out with a hammer using an appropriately sized punch.



STEP 2 (cont.)
b) For riveted construction, the end of the rivet needs to be ground off with a grinder as shown.



STEP 2 b) (cont.)
b) After the rivet end has been removed, drive the rivet out with a hammer using an appropriately sized punch as shown.



4640 Ironwood Dr. • Franklin, WI 53132 • 800.433.7642 • Fax: 414.817.6161

CUSTINFO MetalLidReplacement Kit 050808 B



STEP 3 (For DS60, DS100C and DS100)
Replace the lid and spring making sure that the spring is properly in its seated position. Two washers are provided: one to position under the screw head and the other under the lock nut. Line up the lid hole with the casing mounting holes and insert screw shank through the hole.

STEP 3 (For DS200 Only)
Lid replacement hardware on the DS200 lid consists of:

- One (1) loose DS200 lid rivet
- One (1) #8 - 32 screw, 3" long
- Two (2) #8 washers (small O.D. type)
- One (1) #8 - 32 Nylok locking nut (or equivalent)

Insert the rivet to retain the new lid, making sure that the spring is properly in its seated position. Insert the screw through the I.D. of the rivet to retain it in position. Two washers are provided: one to position under the screw head and the other under the lock nut.

STEP 4
Drive the lock nut onto the screw but do not over-tighten as the lid must be loose enough to pivot about the screw shank.



4640 Ironwood Dr. • Franklin, WI 53132 • 800.433.7642 • Fax: 414.817.6161

CUSTINFO MetalLidReplacement Kit 050808 B